

# App. Note

## Replacement Components for Axcelis GSD ELS and ELS2 Cathodes

- Full Configuration Support
- Bolt on Compatible
- High Purity **Materials**
- Fully **Tungsten** Design

Three total styles of cathodes are available for use on ELS style ion sources. Two are common to ELS and one to ELS2. Although all designs are mountable to any configuration of ELS ion source, careful filament and clamp selection is needed to ensure proper operation. ELS type cathodes are manufactured from high purity **tungsten**, **TZM**, and **molybdenum**. Due to assembly constraints, the ELS and ELS2 style cathodes are not mountable to GSDIII ion sources that have not been converted to the Eterna configuration.

### Assembly

- 1.05.115 GSD ELS Ion Source
- 1.05.130 ELS2 Cathode

### Part

- 74037 Cathode, ELS
- 79198 Cathode, ELS, W
- 98399 Cathode, ELS, W, Can
- 87037 Cathode, GSD ELS2
- 19610 Cathode, ELS2, W
- 19623 Cathode, ELS2, W, Can
- 73530 Cathode Repeller, Moly
- 79263 Cathode Repeller, W

### Application Note

- 2.05.130 ELS2 Cathode

		2-piece TZM-Tungsten Cathode	Monolithic Tungsten Cathode	2-piece Molybdenum-Tungsten Cathode	Can-Style Tungsten Cathode	Molybdenum Cathode Repeller	Tungsten Cathode Repeller
ELS	E/G Part#	74037	79198	n/a	98399	73530	79263
	Cross Ref.#	17142890	17158000	n/a	17158000 (MOD)	17121930	17133340
ELS2	E/G Part#	n/a	19610	87037	19623	73530	79263
	Cross Ref.#	n/a	17246790 (MOD)	17246790	17246790 (MOD)	17121930	17133340

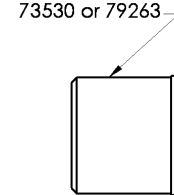
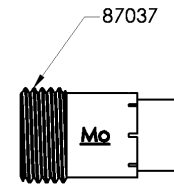
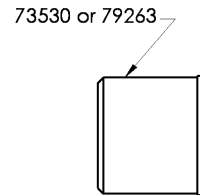
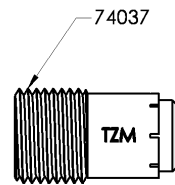

For use with a Molybdenum Source

ELS DESIGN

ELS2 DESIGN

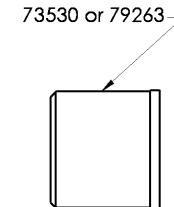
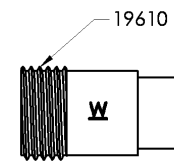
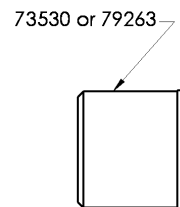
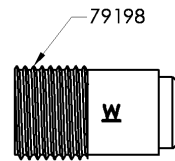

For use with a Tungsten or Molybdenum Source

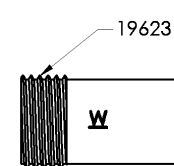
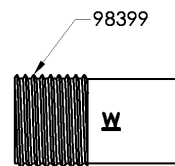

Forward

